

To assist you in finding the location of your Sunday School classes, please use this classroom map. Please turn over to see the classroom assignments.

**Classroom Map 2009**

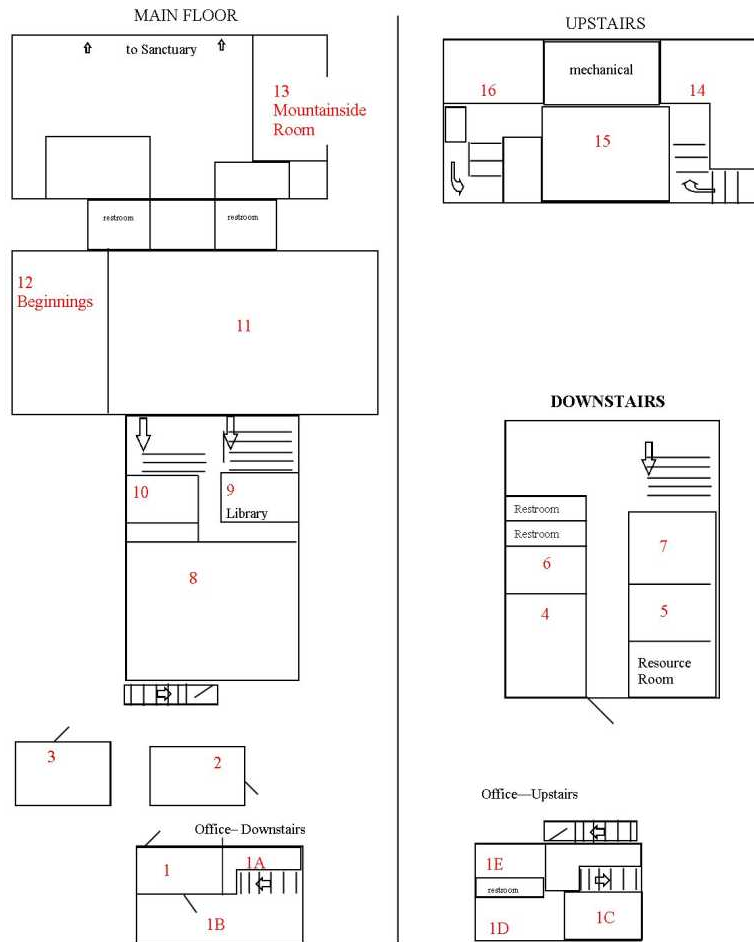

Updated on Thursday, August 14, 2009

**Classrooms and Classroom Placement**

Key Question: How old were you on August 16, 2009?  
Place according to answer

**Class Schedule 9:15 for Fall (Beginning 09/13/09)**

- Infant/Toddler Nursery – Beginnings Room #12 (0-30 months)
- 2/3 Year Olds – Room #7 (30months-3 year olds)
- 4/5 Year Olds – Room #4
- 6/7 Year Olds – Room #14
- 8/9 Girls – outside Building #3
- 8/9 Boys – outside Building #2
- 10 Year Olds – Room #16
- Jr. Youth – Room #15 (ages 11-13)
- Sr. Youth – Room #8 (ages 14-19)
- Adult - Room #11

**Class Schedule 11:00**

- Infant/Toddler Nursery – Beginnings Room #12 (0-30 months)
- 2/3 Year Olds – Room #7 (30months-3 year olds)
- 4/5/6 Year Olds – Room #4